

Impacta ProBase on Concrete

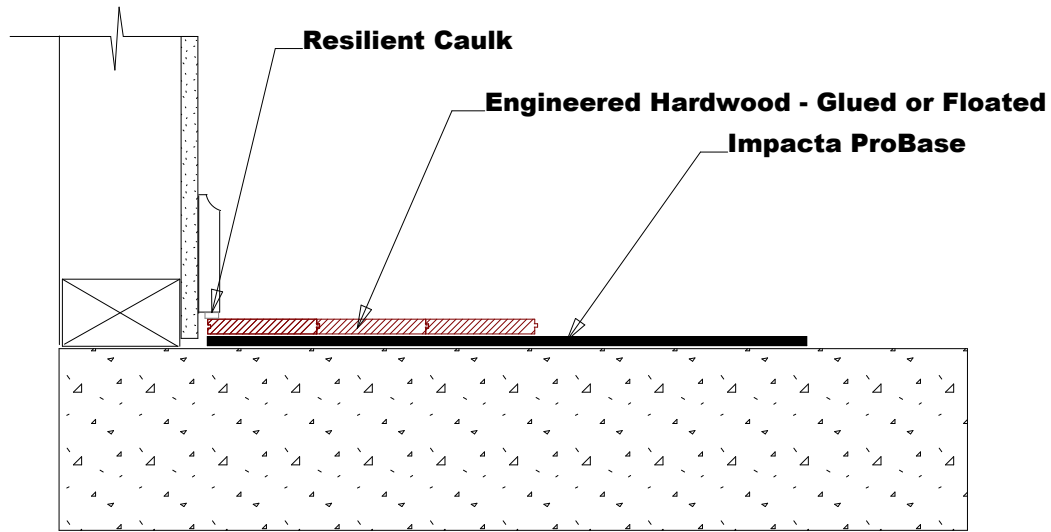

Note:
ProBase can be installed under double glued or floated hardwood. If the floor is floated it is not necessary to glue the ProBase to the sub floor. If the installation is a glue down installation we recommend using a good quality urethane wood adhesive to bond the rubber to the sub floor and the hardwood to the rubber.



Name

Scale

Part / Drawing number