

Impacta-ProBase

Underlayment Raft for Nail Down Hardwood



Impacta-ProBase Raft System allows installation of solid nail-down hardwood flooring using a raft method.

The ProBase rubber is installed from wall to wall—loose lay; lay ½” plywood on top of the ProBase leaving a ½” expansion/acoustic gap around all walls. Install a second ½” layer of plywood making sure of stagger the bottom seam from the top, glue & brad nail the top plywood to the bottom plywood. The plywood floats on top of the ProBase rubber, the nail down hardwood can be fastened into the plywood raft. The expansion gap can be left alone or filled with an acoustic caulk, install baseboard slightly off finished floor.

ProBase underlayment can use 3mm, 5-6mm 10mm or 12mm thick under 2 layers of ½” plywood.

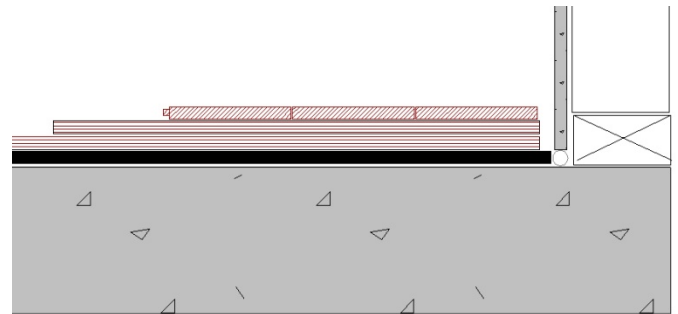

- 92% recycled content, qualifies for up to 5 Leed Points
- IIC rating 50+
- Easy to install, 4' x 25' rolls
- Sound control underlay for nail down Hardwood

Product Data:

Description Made from 92% recycled SBR (Styrene-Butadiene Rubber) tire rubber

Nominal thickness	3mm - 12mm
Density (ASTM D-792)	43 lbs cubic ft
Standard width	48” wide
Roll length	25’ long
Weight	.5 lb - 2.00 lbs per sq ft
Hardness A Shore-Durometer	40-55



Distributed by: